

# Bitterwater / Lonoak Rd Loop

KCK008, 39.6 miles, 1906. feet of climbing

10-04-2010

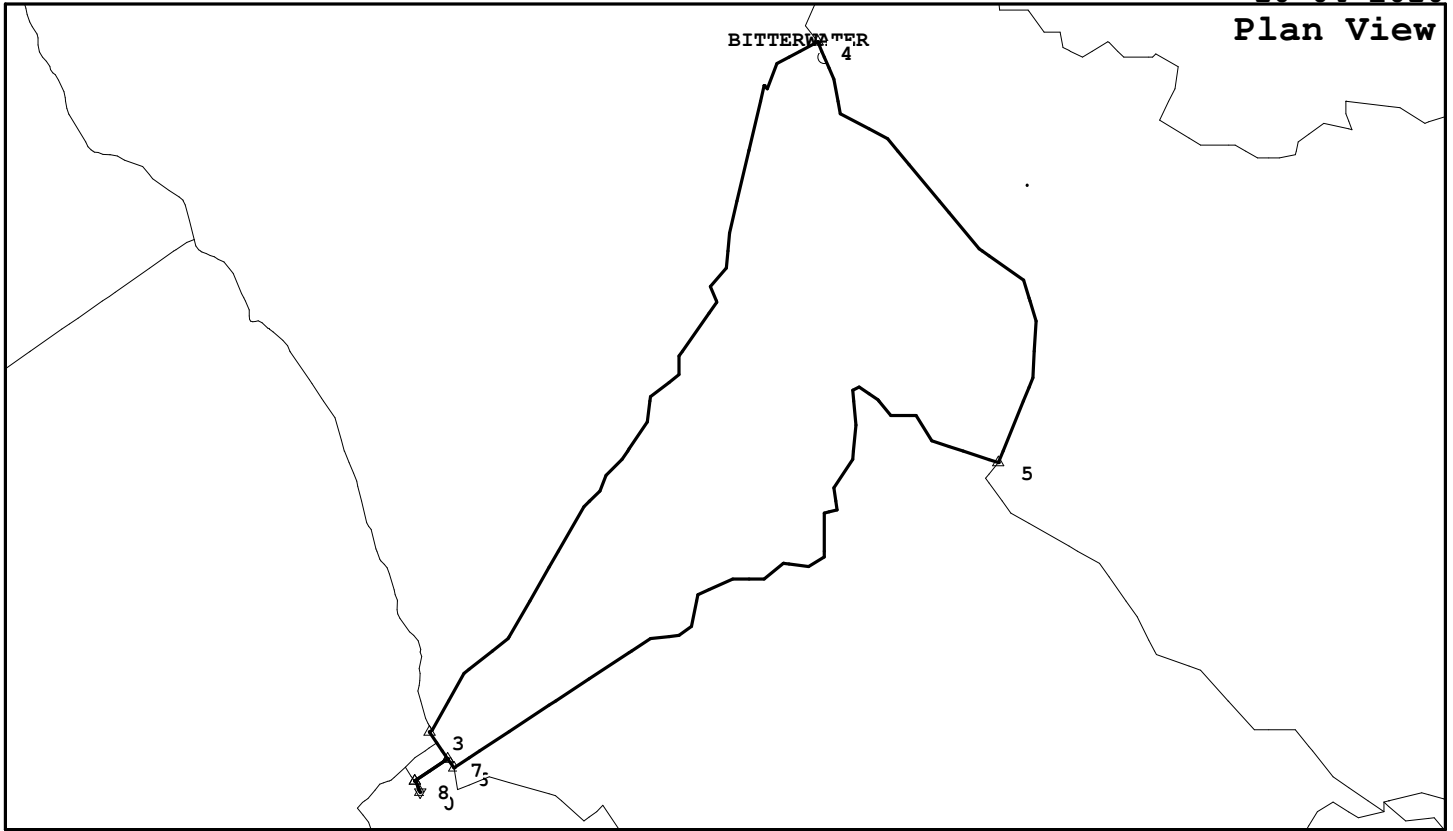

<http://BikeMaster.home.att.net/>

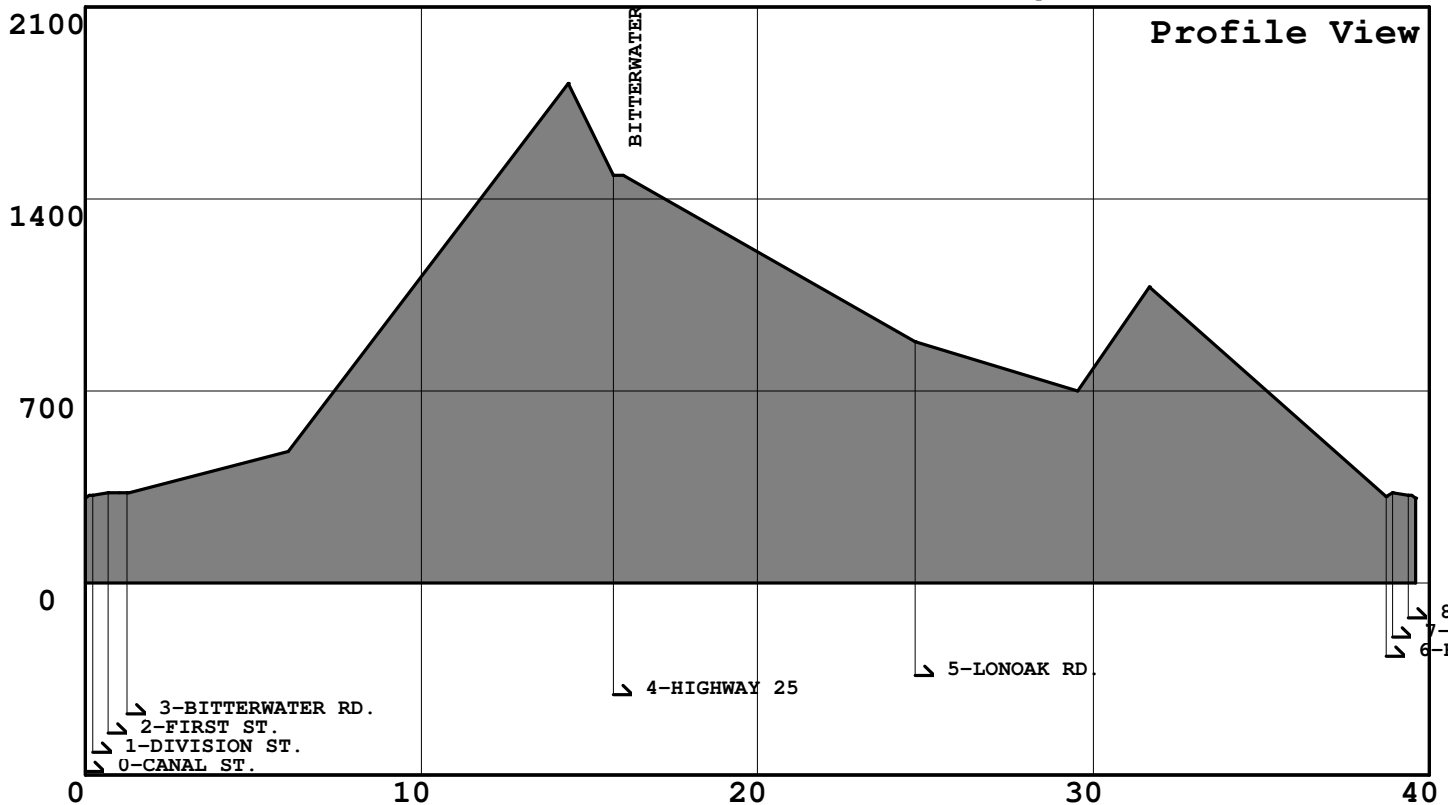

3-BITTERWATER RD.  
2-FIRST ST.  
1-DIVISION ST.  
0-CANAL ST.

4-HIGHWAY 25

5-LONOAK RD.

8-CANAL  
7-DIVISION  
6-FIRST ST.